

PLANS DITCH NO. 16 YELLOW MEDICINE RIVER WATERSHED DISTRICT MINNESOTA

INDEX

- SHEET NO. 1 KEY MAP, INDEX & ESTIMATED QUANTITIES.
- SHEET NO. 2 PLAT OF SECTIONS 18 & 19 IN SANDNES TWP. T.114N., R.40W. & SECTIONS 13, 14, 15, 22, 23 & 24 IN NORMANIA TWP. T.114N., R.41W.
- SHEET NO. 3 PLAT OF SECTIONS 16, 21, 25, 26, 27 & 28 IN NORMANIA TWP. T.114N., R.41W.
- SHEET NO. 4 PROFILE OF MAIN & BRANCH 1.
- SHEET NO. 5 DETAILS OF OPEN DITCH, OUTLET PIPE & TILE INLET.

- EXISTING OPEN DITCH
- PROPOSED OPEN DITCH
- CULVERTS THRU WASTEBANKS
- X PRIVATE CROSSINGS
- - - EXISTING TILE LINES
- - - PROPOSED TILE LINES
- TILE INLETS
- EXTERIOR WATERSHED
- INTERIOR WATERSHED
- ENERGY LINES
- - - TELEPHONE OR UNDERGROUND CABLES
- 1"=660' SCALE ON DETAILED PLATS

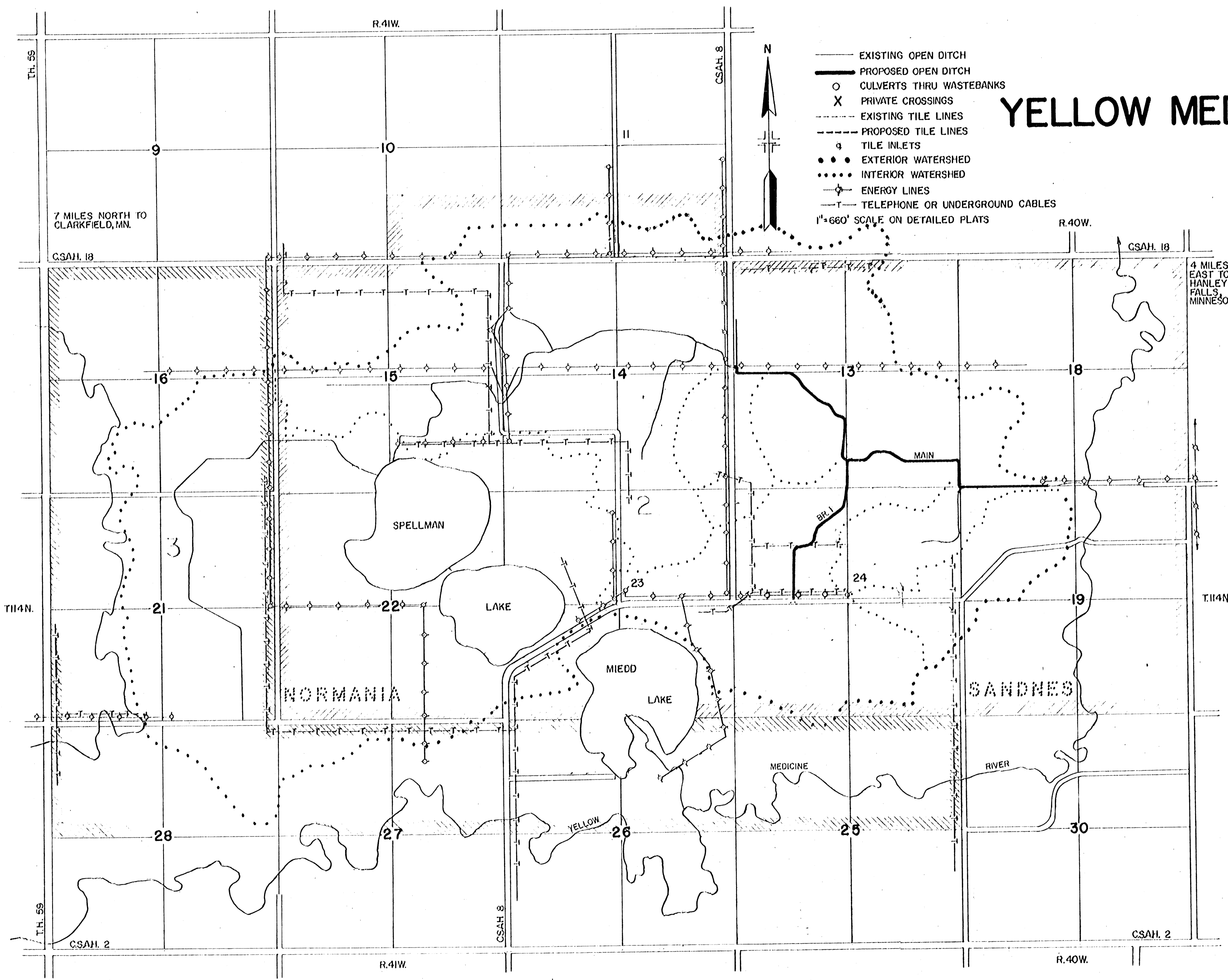

ESTIMATED QUANTITIES

OPEN DITCH							
BRANCH	STA.	TO STA.	LENGTH	BOTTOM	CUBIC YARDS	SEEDING - ACRES	WASTE BANKS
MAIN	0+28	95+42	9,514'	4'	17,279	9.5	7.1
I	0+00	38+90	3,890'	4'	23,348	4.8	2.9
TOTAL			13,404'		40,627	14.3	10.0

CLEARING AND GRUBBING					
BRANCH	SECTION	TWP	RANGE	TREES	STUMPS
MAIN	19	114N	40W	71	98
MAIN	13	114N	41W	4	
I	24	114N	41W	416	
TOTAL				491	98

CULVERTS			
NUMBER	TOTAL LENGTH	SIZE	TYPE
1	40'	66"	RCP II
1	38'	60"	RCP II
2	110'	48"	RCP II
1	20'	24"	CSR 16
6	216'	18"	CSR 16
3	108'	15"	CSR 16
2	72'	12"	CSR 16

REMOVE CULVERTS			
NUMBER	TOTAL LENGTH	SIZE	TYPE
1	32'	72"	CSR
1	33'	60"	CSR
2	62'	38" X 22"	RCP

CHAMBERLAIN ENGINEERING COMPANY, MONTEVIDEO, MINNESOTA

MAPPING	C.W.	12-81	DESIGN	
PRELIM. SURVEY	L.M.	3-81	DRAFTING	
DESIGN	C.B.S.	4-81	REVISED	
DRAFTING	O.B.T.	5-81	CONST. SURVEY	L.T. 9-89
FINAL SURVEY			CORRECTED PLAN	L.T. 3-89

PLANS CORRECTED TO SHOW DITCH AS CONSTRUCTED

DITCH NO. 16
YELLOW MEDICINE RIVER WATERSHED DISTRICT, MINNESOTA

KEY MAP, INDEX & ESTIMATED QUANTITIES SHEET NO. 1